

A white kitchen cabinet with an arched top and open shelving. The cabinet has three main shelves and a bottom section with five small drawers. The text is overlaid on the upper part of the cabinet.

american productsTM

7551 Dutch Road Waterville, Ohio 43566
Phone 419-878-9582 FAX 419-878-9580

The Advantage Line

A complete line of kitchen accessories

American Products & The Advantage Line Catalog

American Products and the Advantage Line Catalog go hand in hand. There are many benefits of using The Advantage Line by American Products. This catalog is your entree' to a world of more satisfied customers, as you use it to call upon our expertise in providing some of the highest quality kitchen accessories in the industry.

American Products designs custom cabinets and accessories, allowing you to provide your customers with the products they desire, giving you the advantage. Our philosophy has always been to produce a higher quality product with careful and continuous attention to meeting the often-customized needs our distributors have come to expect. Consistent quality of product and service have always been the hinge-pins of how we obtain and maintain our customers.

We feel that the quality of a product has as much, or more, to do with excellence and pride in what we produce as it does with technique. Our product line has developed into one of the most comprehensive assortments of accessories in the industry -and it continues to expand.

American Products offers the diversity you need by offering the essential extras. For example, we have a standard Desk Organizer that is available in many sizes, woods and colors. We also have the ability to customize a Desk Organizer to whatever specifications you or your customer may desire. And that is only the beginning. Choose from plate racks and spice drawers to complete entertainment units, what ever the need, American Products will work to give you the advantage.

Our accessories are constructed with a quality that endures, but the aesthetic value of cabinet making is equally as important. They're meant to add beauty.

Ours is not just a passion for quality, but a love for what we produce.

If an advantage is what you are looking for, call American Products today for your custom cabinet and kitchen accessory needs.

american products
7551 Dutch Road
Waterville, OH 43566

TABLE OF CONTENTS

CATEGORY	PRODUCT	CODE	PAGE
TERMS AND CONDITIONS.....			5
Cabinets.....	Base Angle	BAC24	9
	Base End	BE1224, BE2424	9
	Countertop Bookshelf	CTB	15
	Lattice Wine Rack	L/CAB, L/CAB-V	16,17
	Medicine	MC-M, MC-W	15
	Microwave	MS, MSC, MS-V	18
	Plate Rack	P/CAB, P/CAB-FV	19
	Wall Angle	WA	20
	Wall Corner	WC	21
	Wall End	WE	21
	Wine Bottle	WS/CAB , WS/CAB-V	20
Columns.....	Round	RC	13
	Round Fluted	RC-F	13
	Square	CLM	12
	Square Fluted	CLM-F	12
Corbels.....	Acanthus	CA	52
	Grape	CG	52
	Standard	CBL	33
	Traditional Large	CBL-TO1	47
	Traditional Medium	CBL-TO0	47
	Traditional Small	CBL-TX0	47
	Traditional X-Large	CBL-TM1	47
Countertop Support Bracket		CTSB	13
Cup Holder		CH	33
Desk Leg		DL	14
Desk Organizer		DO, DOD	23
Doors.....	Flat Panel	FPD	24
	Mullion Glass	MGD	24
	Raised Panel	RPD	25
Feet.....	Bun	BFB, BFR, BFS	50
	Tulip	TLP	50
Fillers.....	Base	BF, BF-A, BF1*, BF2*, BF3*, BF6*	31,59
	Base Fluted	BFF, BFF-A	31
	Fluted w/Rosette	FFR	31
	Tall	TF, F384*, F396*, F684*, F696*	31,59
	Tall Fluted	TFF	32
	Vanity	VF, VF-A	32
	Vanity Fluted	VFF, VFF-A	32
	Wall	WF, WF-A, F342*, F642*	33,59
	Wall Fluted	WFF, WFF-A	32
Inserts.....	Cutlery Tray Divider	CT, CTV	14
	Lattice Wine Rack	LWR	26
	Plate Rack	PR	25
Moldings.....	Batten	BM, BM1*	36,56
	Countertop	CTM	37,57
	Crown	CCM, CMS, CML*, CTCM*, SCM*	37,38,55,56
	Crown w/Cleat	CCM-C, CMS-C, CML-C*, SCM-C*	37,38,55,56
	Dentil	DM	38,57
	Furniture Base	FBM	38
	Galley Plate Rail	GPR	39
	Inside Corner	ICM	39,57
	"L"	LM	39
	Outside Corner	OCM, OCM1*	39,57
	Outside Corner 135 Degree	AOC*	56
	Quarter Round	QRM	40,57
	Radius Cabinet	RCM	36,58
	Rope	RM	40,58
	Scribe	SB	40,58

MOLDINGS CONTINUED NEXT PAGE-

TABLE OF CONTENTS

CATEGORY	PRODUCT	CODE	PAGE
MOLDINGS CONTINUED-			
Moldings.....	Shoe	SHM*	58
	Spindle Rail	SPR	40
	Toe Kick Cover	TK4, TK45	41,58
	Under Cabinet	UCM	37,59
Onlays.....	Acanthus	ONL-AH2	48
	Acanthus Corner	ONL-AC1	48
	Acanthus Trim	ONL-AT0	48
	Grape	ONL-GTI	48
	Round	CVR	52
	Square	CVS	52
Open End Shelves.....	Base	BOE-S, BOE-V	10
	Custom Peninsula Base	CBOE	11
	Peninsula Base	PBOE-S, PBOE-V	10,11
	Tall	TOE-S, TOE-V	34
	Wall	WN, WN/BK	29,30
Panels.....	Backers	PB84*, PB96*, PB-S96*	60
	Base End	BEP23*, BEP48*, BEP96*	59
	Beaded	BP	41
	Decorative End	BDEP, WDEP, VDEP	41
	Dishwasher Front	DFP	42
	Flat	FP, FP18*, FP30*, FP36*	42,59
	Full Height	FHP84*, FHP96*	59
	Refrigerator / Tall End	EP	43
	Refrigerator Front	RFP	42
	V-groove	VGP	43
	Wall End	WEP30*, WEP36*, WEP42*	60
Rosettes.....	Acanthus Circle	ROS-AC1	49
	Floral Circle Large	ROS-FC1	49
	Floral Circle Small	ROS-FC0	49
	Leaf Square	ROS-LS1	49
Shelves.....	Computer Keyboard	CKS, CKSF	12
	Condiment	CS, CSC, CSCH	22,23
	Cookbook / Laundry	CLS	22
	Furniture Base	FBS	11
	Plywood	PS	34
	Wine Bottle	WS, WS/SGH	30
Spice Door Rack		SDR	28
Spice Drawers		SD, SDB, SDS, SDV	14,27
Stem Glass Holders		SGH, SGHP	28
Storage Racks		SR, SRV	29
Turned Posts.....	Custom Fluted	TPF	51
	Custom Reeded	TPR	51
	Standard	TP	36
Valances.....	Arched	AV	44,60
	Arched Drop	ADV	43
	Arched Fret	AFV	44
	Arched Openings	AO, AO/FF, AO/TP	34, 35
	Fret	FV	45,60
	Fret Blank	FB	45
	Keystone	KV	45
	Scalloped	SV	46,60
	Toe Board	TBV	46
	Traditional	TV	46,60
*MOLDING PROGRAM		*CARTON QUANTITIES ONLY	53-60
CUSTOM GALLERY			61,62
ORDER FORM			63
CUSTOMER FEEDBACK FORM			65

BASE CABINETS & SHELVES

BASE ANGLE CABINET (BAC 24)

Oak Maple
 Hickory/White Cherry

BAC 24

- Void center style available (VCTR)
- Void doors available (VDO)

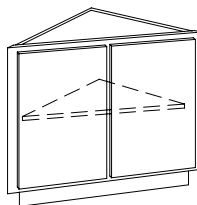

PRODUCT DESCRIPTION

Base cabinet with two full height doors, one adjustable shelf and a center style or partition in the face frame.

BASE END CABINET 1224 (BE1224)

Oak Maple
 Hickory/White Cherry

BE 1224

- Void door available (VDO)

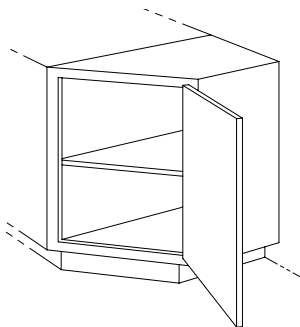

PRODUCT DESCRIPTION

Base cabinet with a full height door and one adjustable shelf. This unit has a 12" deep flush and finished return on exposed side.

Please specify left or right
A right is shown.

BASE END CABINET 2424 (BE2424)

Oak Maple
 Hickory/White Cherry

BE 2424

- Void center style available (VCTR)
- Void doors available (VDO)

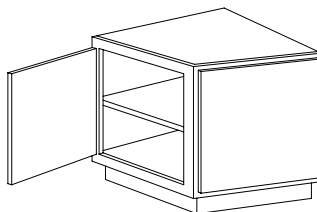

PRODUCT DESCRIPTION

Base cabinet with two full height doors, one adjustable shelf and a center style or partition in the face frame. Matches up with the angles on a Wall End Cabinet to give a consistent appearance.

BASE CABINETS & SHELVES

BASE OPEN END-SOLID WOOD OPTION (BOE-S)

Oak Maple
 Hickory/White Cherry

BOE-S 624- 824
BOE-S 1024-1224
Bendable Toe

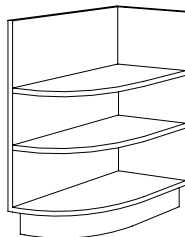

PRODUCT DESCRIPTION

Open shelf typically used at the end of a run of base cabinets. Constructed using a 1/2" back and 3/4" shelves. The shelves on this unit are made of solid hardwood. **Please specify left or right.** A right is shown.

- Top shelf available at a additional cost. (TS)

BASE OPEN END-VENEER OPTION (BOE-V)

Oak Maple
 Hickory/White Cherry

BOE-V 624- 824
BOE-V 1024-1224
Bendable Toe

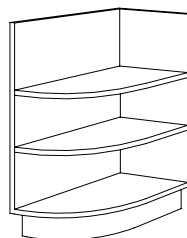

PRODUCT DESCRIPTION

Open shelf typically used at the end of a run of base cabinets. Constructed using a 1/2" back and 3/4" shelves. The shelves on this unit are made with a solid hardwood veneer. **Please specify left or right.** A right is shown.

- Top shelf available at a additional cost. (TS)

PENINSULA BASE OPEN END-SOLID WOOD OPTION (PBOE-S)

Oak Maple
 Hickory/White Cherry

PBOE-S 624- 824
PBOE-S 1024-1224
Bendable Toe

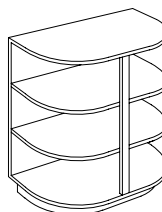

PRODUCT DESCRIPTION

Open shelf typically used at the end of a peninsula. Constructed using a 1/2" back, 3/4" shelves and a center stile for support. The shelves on this unit are made of solid hardwood.

- Turned posts available as substitute for flat center stile at a additional cost. (TP)
- Beaded paneling available for back wall at a additional cost. (BP)

BASE CABINETS & SHELVES

PENINSULA BASE OPEN END-VENEER OPTION

(PBOE-V)

Oak Maple
 Hickory/White Cherry

PBOE-V 624- 824

PBOE-V 1024-1224

Bendable Toe

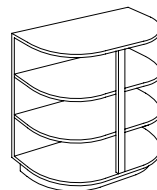

PRODUCT DESCRIPTION

Open shelf typically used at the end of a peninsula. Constructed using a 1/2" back, 3/4" shelves and a center stile for support. The shelves on this unit are made with a solid hardwood veneer.

- Turned posts available as substitute for flat center stile at a additional cost. (TP)
- Beaded paneling available for back wall at a additional cost. (BP)

CUSTOM BASE OPEN END

(CBOE)

Oak Maple
 Hickory/White Cherry

CBOE 624- 824

CBOE 1024-1224

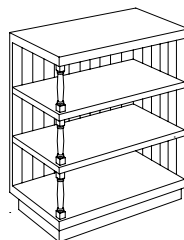

PRODUCT DESCRIPTION

Open shelf typically used at the end of a run of base cabinets. The shelves are supported with turned posts in the front corner. This unit is constructed using 1/2" beaded backs and 3/4" veneer shelves.

Specify left or right.

A right is shown.

- Void beaded panel backs available. (VBP)

FURNITURE BASE SHELVES

(FBS)

Oak Maple
 Hickory/White Cherry

12" DEEP

FBS 2412

FBS 3012

FBS 3612

FBS 4212

24" DEEP

FBS 2424

FBS 3024

FBS 3624

FBS 4224



PRODUCT DESCRIPTION

Base open bookshelf with two adjustable shelves. This unit comes standard with an arched valance top style.

- Void arched valance available. (VAV)

BASE CABINET ACCESSORIES

COMPUTER KEYBOARD SHELF

(CKS) or (CKS-F)

	Oak	Maple Hickory/White	Cherry
CKS	2112		
CKS	2812		
CKS-F	2112		
CKS-F	2812		

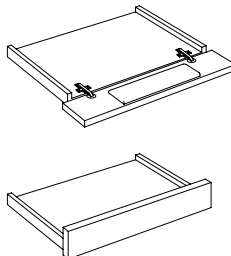

PRODUCT DESCRIPTION

Shallow wooden tray with slides that attaches beneath a countertop or desk top to hold a computer keyboard and, in the larger size, a mouse. Specify if this unit installs into a specific opening size and if it needs to be side mount or under mount.

- CKS-F model includes a flip down front. Drawer front is 3 1/2 inches high.

COLUMNS-NON FLUTED

(CLM)

	Oak	Maple Hickory/White	Cherry
CLM	3 x 3 x 34 1/2		
CLM	4 x 4 x 34 1/2		
CLM	5 x 5 x 34 1/2		
CLM	6 x 6 x 34 1/2		



PRODUCT DESCRIPTION

Square column with no flutes, typically used to support cabinets or countertop overhangs. Unit has a 4 1/2" base as shown in picture below.

- Void base available. (VB)
- Prices are for standard column height of 34 1/2 inches.

COLUMNS-FLUTED

(CLM-F)

	Oak	Maple Hickory/White	Cherry
CLM-F	3 x 3 x 34 1/2		
CLM-F	4 x 4 x 34 1/2		
CLM-F	5 x 5 x 34 1/2		
CLM-F	6 x 6 x 34 1/2		



PRODUCT DESCRIPTION

Square column with flutes, typically used to support cabinets or countertop overhangs. Base is 4 1/2".

- Void base available. (VB)
- Prices are for standard column height of 34 1/2 inches.

BASE CABINET ACCESSORIES

ROUND COLUMN

(RC)

Oak Maple
 Hickory/White Cherry

RC 3
RC 6
RC 9
RC 12



PRODUCT DESCRIPTION

Round, solid wood column with no flutes, typically used to support cabinets or countertop overhangs.

- Prices are for standard column height of 34 1/2 inches.
- Height includes 4 1/2 inch base and 3/4 inch capital unless otherwise specified.

ROUND FLUTED COLUMN

(RFC)

Oak Maple
 Hickory/White Cherry

RFC 3
RFC 6
RFC 9
RFC 12



PRODUCT DESCRIPTION

Round, solid wood column with flutes, typically used to support cabinets or countertop overhangs.

- Prices are for standard column height of 34 1/2 inches.
- Height includes 4 1/2 inch base and 3/4 inch capital unless otherwise specified.

COUNTERTOP SUPPORT BRACKET

(CTSB)

Oak Maple
 Hickory/White Cherry

CTSB 9 x 9
CTSB 12 x 12

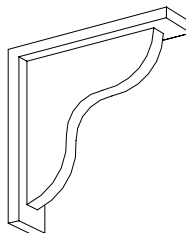

PRODUCT DESCRIPTION

Counter top support bracket comes with 2 1/2" cleat attached to top and back to allow for ease of installation.

BASE CABINETS & ACCESSORIES

CUTLERY TRAY (CT)

Maple

White

CT 12, 15

CT 18, 21

CT 24, 27

CT 30, 33

CT 36, 39

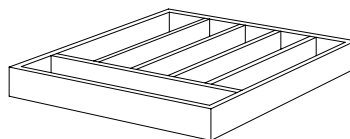

PRODUCT DESCRIPTION

Single drawer insert with interior space divided into one opening at front running parallel to drawer face and equally divided spaces running perpendicular to drawer face. Please provide interior drawer dimensions.

CUTLERY TRAY VERTICAL (CTV)

Maple

White

CTV 12, 15

CTV 18, 21

CTV 24, 27

CTV 30, 33

CTV 36, 39

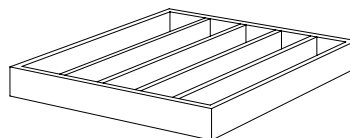

PRODUCT DESCRIPTION

Single drawer insert with interior space divided into evenly spaced openings running perpendicular to the drawer face. Please provide the interior drawer dimensions.

DESK LEG (DL)

Oak

Maple
Hickory/White

Cherry

DL 28 1/2

DL 34 1/2

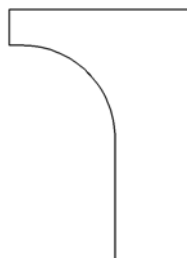

PRODUCT DESCRIPTION

3/4" support leg for a desktop or countertop.

SPICE DRAWER VERTICAL (SDV)

Oak

Maple
Hickory/White

Cherry

SDV 12" Deep

SDV 24" Deep

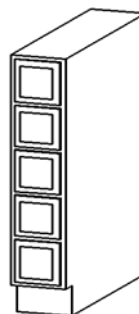

PRODUCT DESCRIPTION

A 6" wide stack of five equally divided drawers. Comes standard with a built on toe space.

COUNTERTOP BOOKSHELVES (CTB)

Maple
Oak Hickory/White Cherry

12" DEEP

CB 181248
CB 211248
CB 241248
CB 181254
CB 211254
CB 241254

18" DEEP

CB 181848
CB 211848
CB 241848
CB 181854
CB 211854
CB 241854

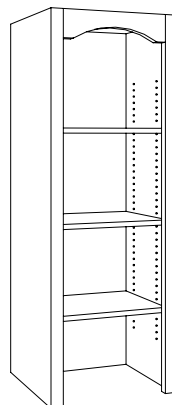

PRODUCT DESCRIPTION

Open bookshelves designed to fit on top of counter spaces. Comes standard with arched valance top stile. **Special shipping charges may apply. Call or fax for a quote.**

- Void arched valance available. (VAV)

MEDICINE CABINET - MIRROR DOOR (MCM)

Maple
Oak Hickory/White Cherry

MCM 1620
MCM 1826
MCM 2430

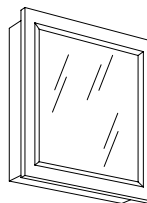

PRODUCT DESCRIPTION

3 3/4" deep cabinet with mirrored glass door. Please specify if recessed or wall mounted. Specify left or right hinging.

MEDICINE CABINET- WOOD DOOR (MCW)

Maple
Oak Hickory/White Cherry

MCW 1620
MCW 1826
MCW 2430

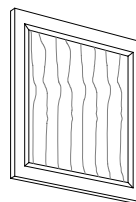

PRODUCT DESCRIPTION

3 3/4" deep cabinet with a wood door, raised or flat panel. Please specify if recessed or wall mounted. Specify left or right hinging.

LATTICE WINE RACK CABINET

(L/CAB) With Face Frame

Oak Maple
Hickory/White Cherry

L/CAB 3315
L/CAB 3915

L/CAB 2718
L/CAB 3318
L/CAB 3918
L/CAB 4518
L/CAB 4818

L/CAB 1224
L/CAB 1524
L/CAB 1824-2418
L/CAB 2124
L/CAB 2424
L/CAB 2724
L/CAB 3324
L/CAB 3924
L/CAB 4524
L/CAB 4824

L/CAB 1230-3012
L/CAB 1530-3015
L/CAB 1830-3018
L/CAB 2130
L/CAB 2430-3024
L/CAB 2730
L/CAB 3030
L/CAB 3330
L/CAB 3630-3036
L/CAB 3930

L/CAB 1236-3612
L/CAB 1536-3615
L/CAB 1836-3618
L/CAB 2136
L/CAB 2436-3624
L/CAB 2736
L/CAB 3336
L/CAB 3636

L/CAB 1242
L/CAB 1542
L/CAB 1842-4218
L/CAB 2442-4224
L/CAB 2742

PRODUCT DESCRIPTION

Lattice wine rack made of 3/4" x 3/8" solid wood slats notched flush and installed in a cabinet with a face frame and matching interior.

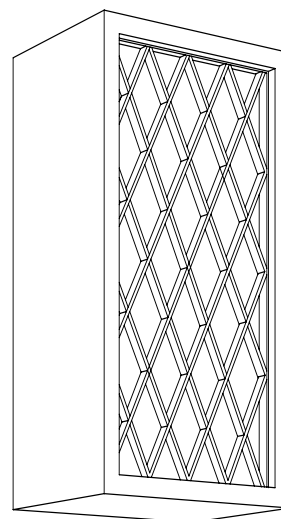

LATTICE WINE RACK CABINET

(L/CAB-V) Without Face Frame

Oak Maple
 Hickory/White Cherry

L/CAB-V 3315
L/CAB-V 3915

L/CAB-V 2718
L/CAB-V 3318
L/CAB-V 3918
L/CAB-V 4518
L/CAB-V 4818

L/CAB-V 1224
L/CAB-V 1524
L/CAB-V 1824-2418
L/CAB-V 2124
L/CAB-V 2424
L/CAB-V 2724
L/CAB-V 3324
L/CAB-V 3924
L/CAB-V 4524
L/CAB-V 4824

L/CAB-V 1230-3012
L/CAB-V 1530-3015
L/CAB-V 1830-3018
L/CAB-V 2130
L/CAB-V 2430-3024
L/CAB-V 2730
L/CAB-V 3030
L/CAB-V 3630-3036
L/CAB-V 3930

L/CAB-V 1236-3612
L/CAB-V 1536-3615
L/CAB-V 1836-3618
L/CAB-V 2136
L/CAB-V 2436-3624
L/CAB-V 2736
L/CAB-V 3336
L/CAB-V 3636

L/CAB-V 1242
L/CAB-V 1542
L/CAB-V 1842-4218
L/CAB-V 2442-4224
L/CAB-V 2742
L/CAB-V 3042-4230
L/CAB-V 3342
L/CAB-V 3642

PRODUCT DESCRIPTION

Lattice wine rack made of 3/4" x 3/8" solid wood slats notched flush and installed in a cabinet **without** a face frame and matching interior. Constructed of 3/4" material.

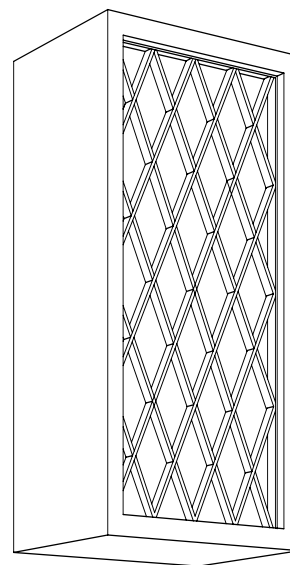

MICROWAVE SHELF

(MS-V) Without Face Frame

Oak Maple
Hickory/White Cherry

MS-V 24
MS-V 30
MS-V 36

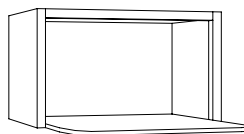

PRODUCT DESCRIPTION

Open cabinet for supporting a microwave oven. Top section is 12" deep, lower section is 18" deep. Constructed of 3/4" material. Specify height (up to 21") when ordering.

MICROWAVE SHELF

(MS) With Face Frame

Oak Maple
Hickory/White Cherry

MS 24
MS 30
MS 36

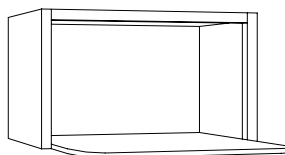

PRODUCT DESCRIPTION

Open cabinet for supporting a microwave oven. Top section is 12" deep, lower section is 18" deep. Specify height (up to 21") when ordering.

MICROWAVE SHELF -CURVED

(MSC)

Oak Maple
Hickory/White Cherry

MSC 24
MSC 30
MSC 36

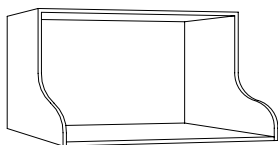

PRODUCT DESCRIPTION

Open cabinet with curved sides for supporting a microwave oven. The curve provides a smooth transition between the upper (12") section and the lower (18") section. Constructed of 3/4" material. Specify height (up to 21") when ordering.

PLATE RACK CABINET

(P/CAB)

Oak Maple
 Hickory/White Cherry

P/CAB 1530
P/CAB 1830
P/CAB 2130
P/CAB 2430
P/CAB 2730
P/CAB 3030
P/CAB 3330
P/CAB 3630

P/CAB 1536
P/CAB 1836
P/CAB 2136
P/CAB 2436
P/CAB 2736
P/CAB 3036
P/CAB 3336
P/CAB 3636

P/CAB 3018
P/CAB 3618
P/CAB 3015
P/CAB 3615

PRODUCT DESCRIPTION

Open cabinet with face frame and plate rack installed. Plate rack opening is 11 1/2" to 14 3/4" high.

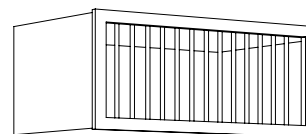
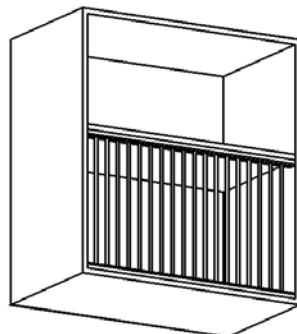

PLATE RACK CABINET w/ FRET VALANCE

(P/CAB/FV)

Oak Maple
 Hickory/White Cherry

P/CAB/FV 1530
P/CAB/FV 1830
P/CAB/FV 2130
P/CAB/FV 2430
P/CAB/FV 2730
P/CAB/FV 3030
P/CAB/FV 3330
P/CAB/FV 3630

P/CAB/FV 1536
P/CAB/FV 1836
P/CAB/FV 2136
P/CAB/FV 2436
P/CAB/FV 2736
P/CAB/FV 3036
P/CAB/FV 3336
P/CAB/FV 3636

PRODUCT DESCRIPTION

Open cabinet with face frame and a plate rack installed and a fret valance top style. Plate rack opening is 11 1/2". Shown with optional corbels (CBL).

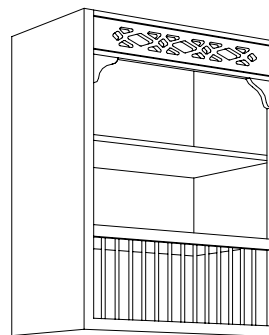

WINE SHELF CABINET

(WS/CAB)

Oak Maple
Hickory/White Cherry

6" TALL UNIT

WS/CAB 30
WS/CAB 36
WS/CAB 39
WS/CAB 42

10" TALL UNIT

WS/CAB 3010
WS/CAB 3610
WS/CAB 3910
WS/CAB 4210

PRODUCT DESCRIPTION

Open cabinet with cut outs to cradle the wine bottles. Mounts beneath existing upper cabinets.

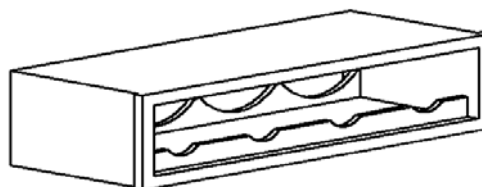

WINE SHELF CABINET- VERTICLE

(WS/CAB-V)

Oak Maple
Hickory/White Cherry

6" WIDE UNIT

WS/CAB-V 63012
WS/CAB-V 63612
WS/CAB-V 63912
WS/CAB-V 64212

10" WIDE UNIT

WS/CAB-V 103012
WS/CAB-V 103612
WS/CAB-V 103912
WS/CAB-V 104212

PRODUCT DESCRIPTION

Open cabinet with equally spaced shelves, each with a cut out to cradle a wine bottle.

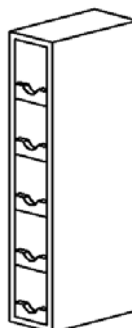

WALL ANGLE

(WA)

Oak Maple
Hickory/White Cherry

WA 24
WA 30
WA 36
WA 42

PRODUCT DESCRIPTION

Wall cabinet with one door and adjustable shelves. Cabinet is 12" x 12" with a 45 degree angled face. Face is 17" across.

Specify left or right hinge.

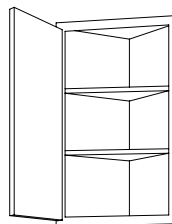

- Void door available. (VDO)

WALL CABINETS

WALL CORNER

(WC)

Oak Maple
Hickory/White Cherry

WC 24
WC2424
WC2430
WC2436
WC2442

WC27
WC2724
WC2730
WC2736
WC2742

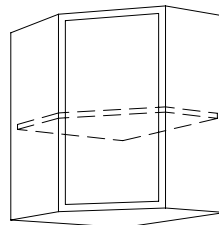

PRODUCT DESCRIPTION

Wall corner cabinet with one door and adjustable shelves. Cabinet is 24" x 24" or 27" x 27" with a 45 degree angled face. Face is 17" across. Specify left or right hinging.

- Void door available. (VDO)

WALL END CABINET

(WE)

Oak Maple
Hickory/White Cherry

WE24
WE30
WE36
WE42

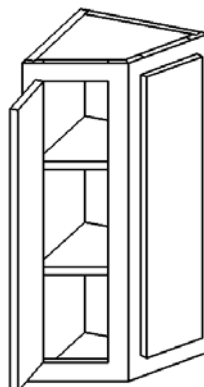

PRODUCT DESCRIPTION

Wall cabinet with two doors, adjustable shelves and a center style. Cabinet is 12" x 12" with a double angled face.

- Void doors available. (VDO)
- Void center style available. (VCTR)

WALL CABINET ACCESSORIES

COOKBOOK LAUNDRY SHELF (CLS)

		Maple	
	Oak	Hickory/White	Cherry
CLS	18		
CLS	24		
CLS	30		
CLS	36		
CLS	42		
CLS	48		

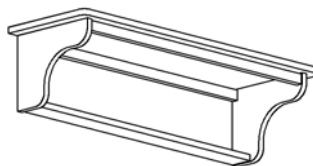

PRODUCT DESCRIPTION

Solid wood shelf 9" high and 12" deep with a 3/4" top. Identical to a condiment shelf except for this unit has a 3/4" thick, 12" deep solid top shelf. Typically wall mounted.

CONDIMENT SHELF (CS)

		Maple	
	Oak	Hickory/White	Cherry
CS	12-15		
CS	18-21		
CS	24-27		
CS	30-33		
CS	36-39		
CS	42-45		

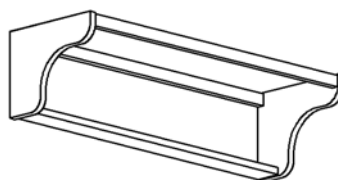

PRODUCT DESCRIPTION

Solid wood shelf 9" high and 11 3/4" deep with a 3 3/4" deep shelf for "condiments". Can be used to transform wasted space beneath a cabinet into an attractive storage area. The ideal under counter space saver.

CONDIMENT SHELF CORNER (CSC)

		Maple	
	Oak	Hickory/White	Cherry
CSC	2424		

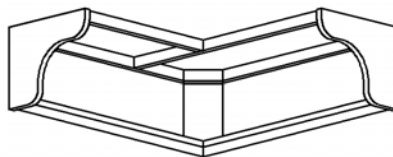

PRODUCT DESCRIPTION

Solid wood shelf 9" high, 24" deep with a 3 3/4" deep space for "condiments". Can be used to transform wasted space beneath a wall corner cabinet into an attractive storage area. The ideal under counter space saver.

WALL CABINET ACCESSORIES

CONDIMENT SHELF CUP HOLDER (CSCH)

Oak Maple
 Hickory/White Cherry

CSCH 12-15
CSCH 18-21
CSCH 24-27
CSCH 30-33
CSCH 36-39
CSCH 42-45

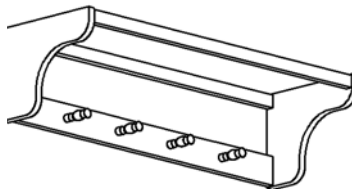

PRODUCT DESCRIPTION

Solid wood shelf, combining a condiment shelf and cup holder for mounting under upper cabinets. Cup holder consists of shaker pegs mounted into a 3 3/4" vertical plate.

DESK ORGANIZER (DO)

Oak Maple
 Hickory/White Cherry

DO 18-21
DO 24-27
DO 30-33
DO 36-39
DO 42-45
DO 48

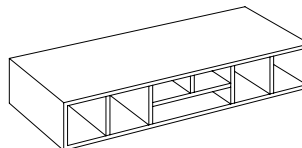

PRODUCT DESCRIPTION

6" high open storage with a 9 1/8" paper slot and other storage slots. Constructed using 1/2" material.

DESK ORGANIZER w/ DRAWERS (DOD)

Oak Maple
 Hickory/White Cherry

DOD 18-21
DOD 24-27
DOD 30-33
DOD 36-39
DOD 42-45
DOD 48

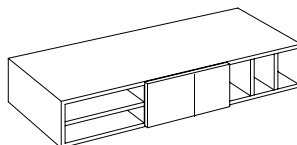

PRODUCT DESCRIPTION

6" high open storage with two 5" drawers in the middle of unit, vertical evenly spaced openings to the right of the drawers and two 9 1/8" wide horizontal slots to the left of the drawers. Configuration may vary from picture, depending on size.

WALL CABINET ACCESSORIES

FLAT PANEL DOORS

(FPD)

Oak Maple
 Hickory/White Cherry

FPD 1230
FPD 1530
FPD 1830
FPD 2130
FPD 2430

FPD 1236
FPD 1536
FPD 1836
FPD 2136
FPD 2436

FPD 1242
FPD 1542
FPD 1842
FPD 2142
FPD 2442

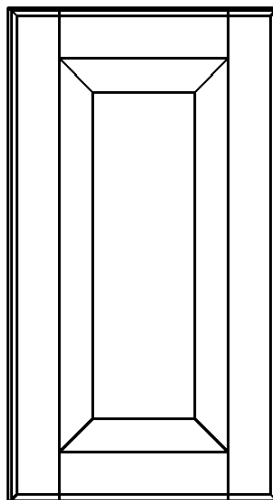

PRODUCT DESCRIPTION

Solid wood frame with flush or recessed veneer panel and a profiled edge. Includes hinges. Specify cabinet line and style. Pricing may vary with different cabinet lines and some profiles may not be available. All doors in white will be painted not thermo foil.

MULLION GLASS DOORS

(MGD)

Oak Maple
 Hickory/White Cherry

MGD 1230
MGD 1530
MGD 1830
MGD 2130
MGD 2430

MGD 1236
MGD 1536
MGD 1836
MGD 2136
MGD 2436

MGD 1242
MGD 1542
MGD 1842
MGD 2142
MGD 2442

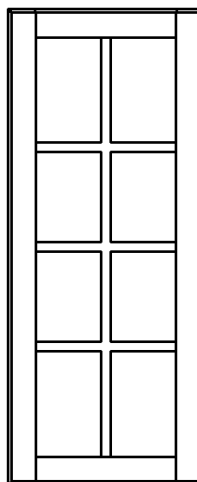

PRODUCT DESCRIPTION

Solid wood frame with solid wood mullions. Price includes hinges and glass clips. Specify cabinet line and style. Pricing may vary with different cabinet lines and some profiles may not be available. All doors in white will be painted not thermo foil.

- Prices **DO NOT** include glass. A 1/4" wood template can be provided upon request.

WALL CABINET ACCESSORIES

RAISED PANEL DOORS

(RPD)

Oak Maple
Hickory/White Cherry

RPD 1230
RPD 1530
RPD 1830
RPD 2130
RPD 2430

RPD 1236
RPD 1536
RPD 1836
RPD 2136
RPD 2436

RPD 1242
RPD 1542
RPD 1842
RPD 2142
RPD 2442

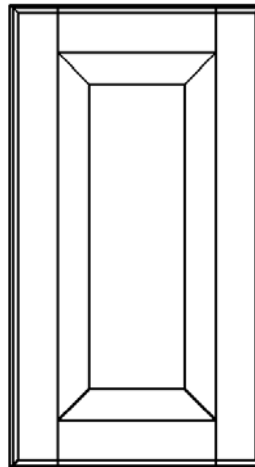

PRODUCT DESCRIPTION

Solid wood frame and raised panel. Includes hinges. Specify cabinet line and style.

Pricing may vary with different cabinet lines and some profiles may not be available. All doors in white will be painted not thermo foil.

PLATE RACK

(PR)

Oak Maple
Hickory/White Cherry

PR 18
PR 21
PR 24
PR 27
PR 30
PR 33
PR 36
PR 39
PR 42

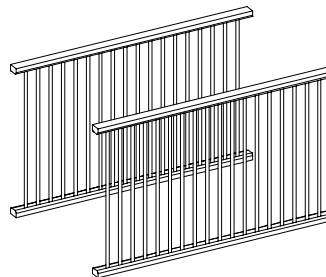

PRODUCT DESCRIPTION

Wood insert with holes bored into them to hold 3/8" dowels spaced every 2", allowing plates to be stored in a vertical position and cradled by each set of dowels. Each plate rack comes with a front and rear pair of rails. Can be ordered over sized and cut to length. All dowels sent loose and oversized for trimming when installed.

WALL CABINET ACCESSORIES

LATTICE WINE RACK

(LWR)

Oak Maple
Hickory/White Cherry

LWR 3315
LWR 3915

LWR 2718
LWR 3318
LWR 3918
LWR 4518
LWR 4818

LWR 1224
LWR 1524
LWR 1824-2418
LWR 2124
LWR 2424
LWR 2724
LWR 3324
LWR 3924
LWR 4524
LWR 4824

LWR 1230-3012
LWR 1530-3015
LWR 1830-3018
LWR 2130
LWR 2430-3024
LWR 2730
LWR 3030
LWR 3330
LWR 3630-3036
LWR 3930

LWR 1236-3612
LWR 1536-3615
LWR 1836-3618
LWR 2136
LWR 2436-3624
LWR 2736
LWR 3336
LWR 3636

LWR 1242
LWR 3342
LWR 3642
LWR 1542
LWR 1842-4218
LWR 2142
LWR 2442-4224
LWR 2742
LWR 3042-4230

PRODUCT DESCRIPTION

Solid wood 3/4" x 3/8" slats that are notched flush and meant to install into an existing cabinet. Consists of a front and a rear lattice.

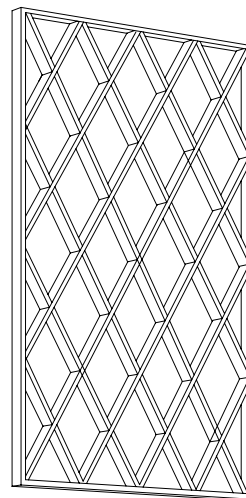

ORDERING LATTICE WINE RACKS

LWR'S need to be ordered by what size cabinet they are being installed into. A 1530 is not the same as a 3015. Example: a 1530 turned on its side is not a 3015, it is still a 1530 and must be ordered as such.

WALL CABINET ACCESSORIES

SPICE DRAWER

(SD)

Oak Maple
 Hickory/White Cherry

SD 12-15 (2 Drawers)
SD 18-24 (3 Drawers)
SD 27-33 (4 Drawers)
SD 36-42 (5 Drawers)

- Available as a vertical. See page 14.

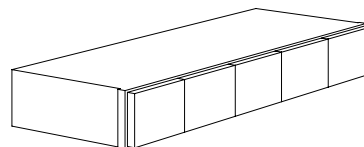

PRODUCT DESCRIPTION

6" high unit of equally divided drawers. Specify cabinet line and door style when ordering.

SPICE DRAWER SINGLE

(SDS)

Oak Maple
 Hickory/White Cherry

SDS 9-15
SDS 18-24
SDS 27-33
SDS 36-42

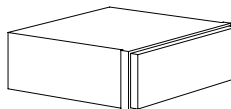

PRODUCT DESCRIPTION

6" high unit with one full width drawer. Specify cabinet line and door style when ordering.

SPICE DRAWER BANK

(SDB)

Oak Maple
 Hickory/White Cherry

SDB 9-15
SDB 18-24
SDB 27-33
SDB 36-42

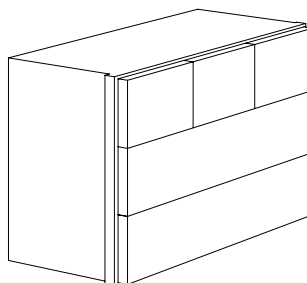

PRODUCT DESCRIPTION

18" high bank of drawers. Two full width drawers on the bottom and middle with three evenly divided drawers on the top row. The number of drawers in the top row may vary with size.

WALL CABINET ACCESSORIES

SPICE DOOR RACK

(SDR)

Maple

White

SDR 12
SDR 15
SDR 18
SDR 21
SDR 24
SDR 27
SDR 30

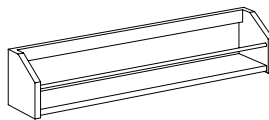

PRODUCT DESCRIPTION

Shallow rack that mounts to the inside of a cabinet door. Unit is 3" deep and 4 3/4" high.

STEM GLASS HOLDER

(SGH)

Maple
Oak Hickory/White Cherry

SGH 12-15
SGH 18-21
SGH 24-27
SGH 30-33
SGH 36-39
SGH 42-45
SGH 48-51
SGH 54-57

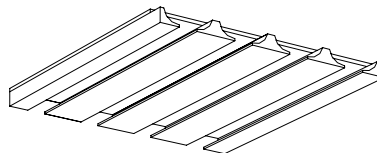

PRODUCT DESCRIPTION

Solid wood rails on a 1/4" flat panel for open display and storage of stemware pieces. Mounts in recess underneath upper cabinets.

STEM GLASS HOLDER PLYWOOD

(SGHP)

Maple
Oak Hickory/White Cherry

SGHP 12-15
SGHP 18-21
SGHP 24-27
SGHP 30-33
SGHP 36-39
SGHP 42-45
SGHP 48-51
SGHP 54-57

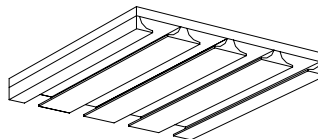

PRODUCT DESCRIPTION

Solid wood rails on a 3/4" flat panel for open display and storage of stemware pieces. Meant to install in a specific opening size, possibly between two cabinets.

WALL CABINET ACCESSORIES

STORAGE RACK & STORAGE RACK VERTICLE (SR) & (SR-V)

Oak/White Maple/Hickory Cherry

SR 18-21
SR 24-27
SR 30-33
SR 36-39
SR 42-45
SR 48

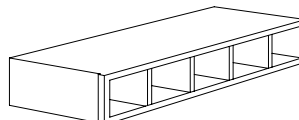

- Vertical unit priced the same as above.

PRODUCT DESCRIPTION

6" high pen storage with evenly spaced openings. The unit is constructed using 1/2" material.

WHAT NOT SHELF (WN) 1/2" BACK

Oak Maple
Hickory/White Cherry

WN 43012- 63012
WN 83012-103012
WN 123012-143012
WN 43612- 63612
WN 83612-103612
WN 123612-143612
WN 44212- 64212
WN 84212-104212
WN 124212-144212

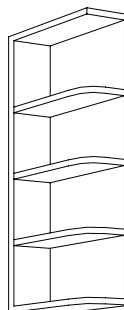

PRODUCT DESCRIPTION

Open shelf typically used at the end of a run of upper cabinets. This version features a 1/2" back to provide greater structural stability.

SPECIFY LEFT OR RIGHT

Left is shown with SQT.

- Available with square or mitered top for use with Crown Molding. (SQT) or (MRT)
- 3 3/4" radius up to 9" -5 1/4" radius from 10" and up.
- WN 30, 36 have 9", 11" spacing, 4 shelves and WN 42 has 9 9/16" spacing, 5 shelves.

WALL CABINET ACCESSORIES

WHAT NOT SHELF

(WN/BK) 1/4" BACK

Oak Maple
 Hickory/White Cherry

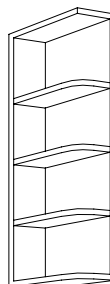

PRODUCT DESCRIPTION

Open shelf typically used at the end of a run of upper cabinets. This WN has a 1/4" back which is designed to fit behind the scribe of an adjacent cabinet.

SPECIFY LEFT OR RIGHT.

Left is shown with SQT.

WN/BK 43012- 63012
WN/BK 83012-103012
WN/BK 123012-143012
WN/BK 43612- 63612
WN/BK 83612-103612
WN/BK 123612-143612
WN/BK 44212- 64212
WN/BK 84212-104212
WN/BK 124212-144212

- Available with square or mitered top for use with Crown Molding. (SQT) or (MRT)
- 3 3/4" radius up to 9" -5 1/4" radius from 10" and up.
- WN 30, 36 have 9", 11" spacing, 4 shelves and WN 42 has 9 9/16" spacing, 5 shelves.
- WN 9" and above we recommend using a 1/2" Back.

WINE SHELF

(WS)

Oak Maple
 Hickory/White Cherry

WS 18
WS 24
WS 30
WS 36
WS 42

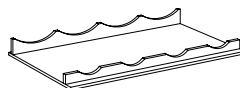

PRODUCT DESCRIPTION

Vertical rails mounted on a flat 1/2" board of the same wood species with half circle cuts to hold bottles in a horizontal position.

- Available as a vertical. See page 20.

WINE SHELF w/ STEM GLASS HOLDER

(WS/SGH)

Oak Maple
 Hickory/White Cherry

WS/SGH 18
WS/SGH 24
WS/SGH 30
WS/SGH 36
WS/SGH 42



PRODUCT DESCRIPTION

Wine Shelf with Stem Glass Holder attached to under side. Designed to fit in a specific opening size.

For example: Between two cabinets or a cabinet and a wall.

FILLERS

BASE FLUTED FILLER & BASE FLUTED FILLER- ANGLED (BFF) & (BFF-A)

Maple
Oak Hickory/White Cherry

BFF 3
BFF 6
BFF-A 4 1/4

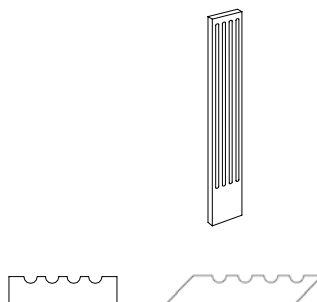

PRODUCT DESCRIPTION

Solid wood 3/4" board with routed grooves. Pieces are 34 1/2" tall and trim able to 30".

BFF-A is angled at 45 degrees with a 4 1/4" face.

Specify Left or Right.

BASE FILLER & BASE FILLER- ANGLED (BF) & (BF-A)

Maple
Oak Hickory/White Cherry

BF 3
BF 6
BF-A 4 1/4

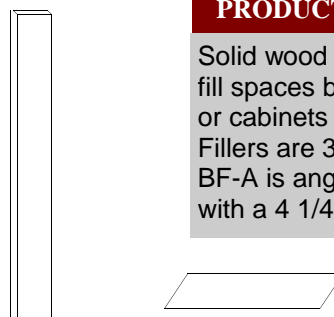

PRODUCT DESCRIPTION

Solid wood 3/4" board used to fill spaces between cabinets or cabinets and walls, etc. Fillers are 34 1/2" tall. BF-A is angled at 45 degrees with a 4 1/4" face.

FLUTED FILLER w/ ROSETTE (FFR)

Maple
Oak Hickory/White Cherry

FFR 3 12-18
FFR 3 21-30
FFR 3 33-39



PRODUCT DESCRIPTION

Solid wood 3/4" board with routed grooves and a rosette at one end. Rosette is drilled into filler or a square block of wood with a drilled profile attached to the face of the filler. **Please specify which is desired.**

TALL FILLER (TF)

Maple
Oak Hickory/White Cherry

TF 3 x 84
TF 3 x 96
TF 6 x 84
TF 6 x 96

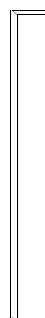

PRODUCT DESCRIPTION

Solid wood 3/4" board.

FILLERS

TALL FLUTED FILLER

(TFF)

Maple
Oak Hickory/White Cherry

TFF 3 x 84
TFF 3 x 90-96
TFF 6 x 84
TFF 6 x 90-96



PRODUCT DESCRIPTION

Solid wood 3/4" board with routed grooves.

VANITY FLUTED FILLER & VANITY FLUTED FILLER- ANGLED

(VFF) & (VFF-A)

Maple
Oak Hickory/White Cherry

VFF 3
VFF 6
VFF-A 4 1/4



PRODUCT DESCRIPTION

Solid wood 3/4" board with routed grooves. Pieces are 31 1/2" tall and can be trimmed to 27".
VFF-A is angled at 45 degrees with a 4 1/4 face.

Specify Left or Right.

VANITY FILLER & VANITY FILLER- ANGLED

(VF) & (VF-A)

Maple
Oak Hickory/White Cherry

VF 3
VF 6
VF-A 4 1/2

31 1/2" High

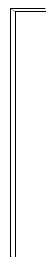

PRODUCT DESCRIPTION

Solid wood 3/4" board. Pieces are 31 1/2" tall.



WALL FLUTED FILLERS & WALL FLUTED FILLERS- ANGLED

(WFF) & (WFF-A)

Maple
Oak Hickory/White Cherry

WFF 3 12-18
WFF 3 21-30
WFF 3 33-39
WFF 3 42-48

WFF 6 12-18
WFF 6 21-30
WFF 6 33-39
WFF 6 42-48



PRODUCT DESCRIPTION

Solid wood 3/4" board with routed grooves.
6" wide fillers are available angled at 45 degrees with a 4 1/4" face. Product code is WFF-A. WFF-A prices are the same as the standard 6" filler prices.

- WFF-A ORDERED BY LENGTH, PRICE AT APPROPRIATE WFF-6 LENGTH FROM ABOVE

FILLERS

WALL FILLER & WALL FILLER- ANGLED (WF) & (WF-A)

Maple
Oak Hickory/White Cherry

WF 3 12-18
WF 3 21-30
WF 3 33-39
WF 3 42-48

WF 6 12-18
WF 6 21-30
WF 6 33-39
WF 6 42-48

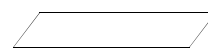
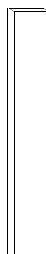

PRODUCT DESCRIPTION

Solid wood 3/4" board. 6" wide fillers are available angled at 45 degrees with a 4 1/4" face. Product code is WF-A. WF-A prices are the same as the standard 6" filler prices.

- WF-A ORDERED BY LENGTH, PRICE AT APPROPRIATE WF-6 LENGTH FROM ABOVE

MISC.

CORBELS (CBL)

Maple
Oak Hickory/White Cherry

CBL 2 1/2 x 5 SM.
CBL 4 x 5 MED.
CBL 5 1/2 x 8 LG.
CBL 9 x 12 X-LG.

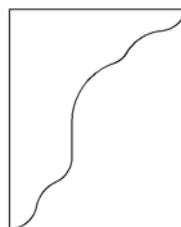

PRODUCT DESCRIPTION

Decorative corner braces used to support counter tops or soften corners of open cabinets.

- Corbels are sold in pairs.
- Also, see architecturally carved corbels on pages 47 & 52.

CUP HOLDER (CH)

Maple
Oak Hickory/White Cherry Capacity

CH 18	3
CH 24	4
CH 30	5
CH 36	6
CH 42	8
CH 48	9

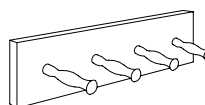

PRODUCT DESCRIPTION

Solid wood 3/4" back plate with wooden pegs evenly spaced every 4" for hanging tea cups or coffee mugs.

MISC.

3/4" SHELVING

(PS)

Maple
Oak Hickory/White Cherry

PS 12
PS 24

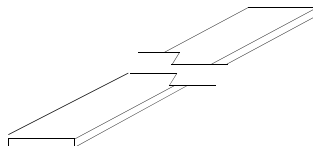

PRODUCT DESCRIPTION

3/4" shelving, 12" deep and up to 8' long. Priced per lineal foot. Round up to the next highest foot.

TALL OPEN END-SOLID WOOD OPTION

(TOE-S)

Maple
Oak Hickory/White Cherry

TOE-S 624- 824
TOE-S 1024-1224
Bendable Toe



PRODUCT DESCRIPTION

Open shelf unit used at the end of a cabinet run. Unit is constructed with 1/2" backs and solid wood shelves. Please specify Left or Right. Left is shown.

- Please specify height 84", 90", or 96". Pricing is the same.

TALL OPEN END-VENEER OPTION

(TOE-V)

Maple
Oak Hickory/White Cherry

TOE-V 624- 824
TOE-V 1024-1224
Bendable Toe



PRODUCT DESCRIPTION

Open shelf unit used at the end of a cabinet run. Unit is constructed with 1/2" backs and solid hardwood veneer shelves. Please specify Left or Right. Left is shown.

- Please specify height 84", 90", or 96". Pricing is the same.

ARCHED OPENING

(AO)

Maple
Oak Hickory/White Cherry

AO 12-18
AO 21-27
AO 30-36
AO 39-45
AO 48-54

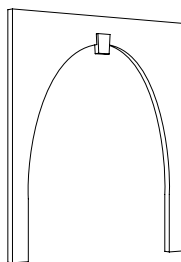

PRODUCT DESCRIPTION

Overlay for cabinets or to fill any opening to create a custom appearance. AO's are made to general specifications relating to size and proportion.

ARCHED OPENING w/ TURNED POSTS (AO/TP)

Oak Maple
 Hickory/White Cherry

AO/TP 1530
AO/TP 2430
AO/TP 2436
AO/TP 3642
AO/TP 3648

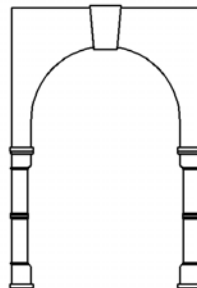

PRODUCT DESCRIPTION

American Products' Custom Arched Opening mounted atop Turned Posts and used to enhance the appearance of open shelving, space around a sink window, etc.

ARCHED OPENING w/ FLUTED FILLERS (AO/FF)

Oak Maple
 Hickory/White Cherry

AO/FF 1530
AO/FF 2430
AO/FF 2436
AO/FF 3642
AO/FF 3648

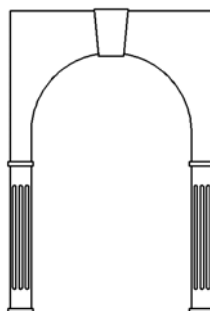

PRODUCT DESCRIPTION

American Products' Custom Arched Opening mounted atop Fluted Fillers and used to enhance the appearance of open shelving, space around a sink window, etc.

MISC.

TURNED POSTS

(TP)

Oak Maple
Hickory/White Cherry

2" SQUARE

TP 9-12"
TP 15-18"
TP 21-24"

3 1/2" SQUARE

TP 31 1/2"-34 1/2"
TP 36"-42"

4 1/2" SQUARE

TP 31 1/2"-34 1/2"
TP 36"-42"

5-6" SQUARE

TP 31 1/2"-34 1/2"
TP 36"-42"

- Turned Posts can be halved for an additional 10%.



PRODUCT DESCRIPTION

Turned posts are constructed of solid wood and turned to resemble picture at left. Smaller posts are used to support small decorative shelves while the larger ones are typically used to support countertop overhangs.

MOLDINGS— See inserts on Pages 53-59 for quantity pricing and other molding offerings.

BATTEN

(BM)

Oak Maple
Hickory/White Cherry



BM 96

PRODUCT DESCRIPTION

3/4" x 1/4" accent strip with a radius on two edges.

RADIUS CABINET MOLDING

(RCM)

Oak Maple
Hickory/White Cherry



RCM 96

PRODUCT DESCRIPTION

Molding used underneath or above upper cabinets with a bull nose edge of double round over.

MOLDINGS

UNDER CABINET MOLDING (UCM)

Maple
Oak Hickory/White Cherry

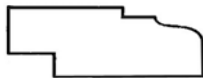

UCM 96

PRODUCT DESCRIPTION

Fastens to bottom of upper cabinets to provide finished appearance and conceal under cabinet lighting.

CLASSIC CROWN MOLDING (CCM)

Maple
Oak Hickory/White Cherry

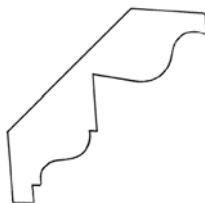

CCM 96

PRODUCT DESCRIPTION

Solid wood molding with a 3/4" space for fastening an accent strip: dentil, rope, etc. Used an accent above upper cabinets.

CLASSIC CROWN MOLDING w/ CLEAT (CCM-C)

Maple
Oak Hickory/White Cherry



CCM-C 96

PRODUCT DESCRIPTION

Solid wood molding with a 2" cleat and a 3/4" space for fastening an accent strip. The cleat allows the molding to be extended from the face of the cabinets and allows it to be used with full overlay doors and frameless cabinets.

COUNTER TOP (CTM)

Maple
Oak Hickory/White Cherry



CTM 96

PRODUCT DESCRIPTION

Typically used on the edge of wood or laminate countertops.

MOLDINGS

CROWN MOLDING (CMS)

Oak Maple
Hickory/White Cherry

CMS 96

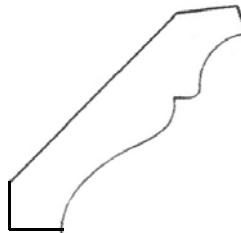

PRODUCT DESCRIPTION

Decorative molding used on top of upper cabinets to provide a decorative finished appearance.

CROWN MOLDING w/ CLEAT (CMS-C)

Oak Maple
Hickory/White Cherry

CMS-C 96

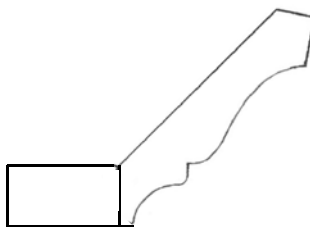

PRODUCT DESCRIPTION

Decorative molding used on top of upper cabinet to provide a finished appearance. Can be used with full overlay doors or frameless cabinets. 2" cleat aids installation.

DENTIL MOLDING (DM)

Oak Maple/White Cherry

DM 96

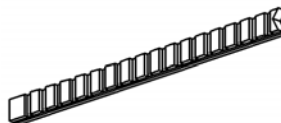

PRODUCT DESCRIPTION

5/8" x 1/4" accent molding typically used in combination with Classic Crown molding.

FURNITURE BASE MOLDING (FBM)

Oak Maple
Hickory/White Cherry

- Alternate profiles available. Please specify via drawing.



PRODUCT DESCRIPTION

Flat solid wood board with a simple profile, used to hide toe space.

MOLDINGS

GALLEY PLATE RAIL

(GPR)

Maple
Oak Hickory/White Cherry

GPR 72
GPR 96



PRODUCT DESCRIPTION

Molding typically used to accent the top of upper cabinets.

INSIDE CORNER

(ICM)

Maple
Oak Hickory/White Cherry

ICM 96



PRODUCT DESCRIPTION

3/4" x 3/4" molding used to hide discrepancies on inside corners.

"L" MOLDING

(LM)

Maple
Oak Hickory/White Cherry

LM 2 x 96, 4 x 96
LM 6 x 96, 8 x 96
LM 10 x 96, 12 x 96

- Specify if profile desired on outer edge along with profile type.
- Add to list price when requesting a profiled edge.

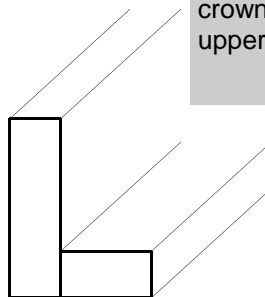

PRODUCT DESCRIPTION

Flat molding with a 2" cleat used to extend the height of crown molding above top of upper cabinets.

OUTSIDE CORNER

(OCM)

Maple
Oak Hickory/White Cherry

OCM 96



PRODUCT DESCRIPTION

3/4" x 3/4" molding with a 1/2" inside corner.

MOLDINGS

QUARTER ROUND

(QRM)

Oak Maple
Hickory/White Cherry

QRM 96



PRODUCT DESCRIPTION

3/4" x 3/4" molding with a radius on one side. Typically used around base.

ROPE MOLDING

(RM)

Oak Maple
Hickory/White Cherry

RM 96

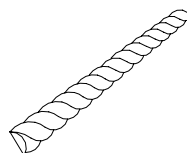

PRODUCT DESCRIPTION

3/4" X 3/8" accent molding typically used with classic crown, skirt or "L" moldings.

SCRIBE

(SB)

Oak Maple
Hickory/White Cherry

SB 96



PRODUCT DESCRIPTION

3/4" X 1/4" molding with a radius edge.

SPINDLE RAIL

(SPR)

Oak Maple
Hickory/White Cherry

SPR 72

SPR 96



PRODUCT DESCRIPTION

Smaller version of galley plate rail without the plate groove.

MOLDINGS

TOE KICK COVER 4" & 4 1/2" (TK4) & (TK45)

Oak Maple
Hickory/White Cherry

TK 4 x 96
TK 4 1/2 x 96

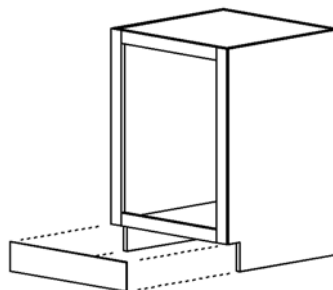

PRODUCT DESCRIPTION

Solid wood veneer 3/16" plywood to provide continuity in toe space area.

PANELS

BEADED PANEL (BP)

Oak Maple/White Hickory/Cherry

BP 48 x 36
BP 48 x 48
BP 48 x 96
BP 96 x 48



PRODUCT DESCRIPTION

1/4" plywood with "beads". Consists of 2 parallel grooves 1/4" apart, spaced every 1 1/2" providing a "beaded" appearance. Custom spacing available. Fax for quote.

BASE & WALL DECORATIVE END PANEL (BDEP) (VDEP) & (WDEP)

Oak Maple
Hickory/White Cherry

BASE & VANITY CABINETS

BDEP 24 x 29
BDEP 16-18 x 34 1/2
BDEP 21-24 x 34 1/2
VDEP 16-21 x 31 1/2

UPPER CABINETS

WDEP 12 x 12
WDEP 12 x 15
WDEP 12 x 18
WDEP 12 x 24
WDEP 12 x 27
WDEP 12 x 30
WDEP 12 x 36
WDEP 12 x 42

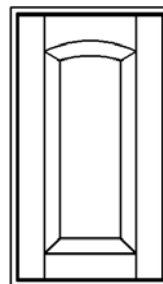

PRODUCT DESCRIPTION

Typically used on base or upper cabinets to hide vinyl end panel. Specify cabinet line and style. Pricing may vary with different cabinet lines and some profiles may not be available. All doors in white will be painted not thermo foil.

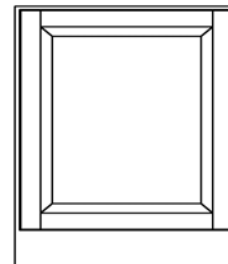

DISHWASHER DOOR PANEL (DFP)

Oak Maple
Hickory/White Cherry

DFP Per Mfr.
Specifications

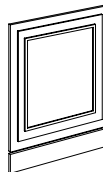

- Stronger springs may be required due to additional weight.
- Confirm manufacturer's recommendations and compatibility prior to ordering.
- Full overlay styles are available. Please specify which is desired.

PRODUCT DESCRIPTION

Solid wood veneer 1/4" panel with 3/4" door attached to cover dishwasher front. Specify cabinet line and style. Pricing may vary with different cabinet lines and some profiles may not be available. All doors in white will be painted not thermo foil. **Factory specifications required.**

FLAT PANEL (FP)

Oak Maple
Hickory/White Cherry

FP 48 x 36
FP 48 x 48
FP 48 x 96
FP 96 x 48

36-96"

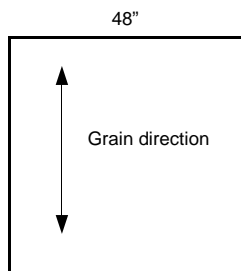

PRODUCT DESCRIPTION

1/4" solid wood veneer panels finished to match cabinets specified.

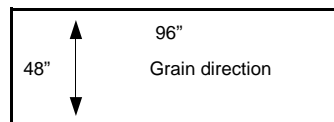

REFRIGERATOR FRONT PANELS (RFP)

Oak Maple
Hickory/White Cherry

RFP (PER SQUARE INCH)

- Panels are priced by the square inch.
- Full overlay styles are also available. Please specify which is desired.

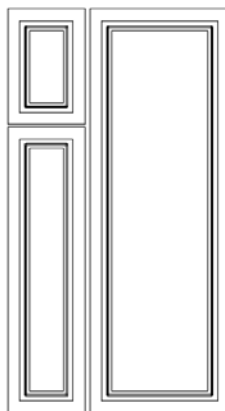

PRODUCT DESCRIPTION

Solid wood veneer 1/4" panel with 3/4" doors attached to cover refrigerator fronts. Specify cabinet line and style. Pricing may vary with different cabinet lines and some profiles may not be available. All doors in white will be painted not thermo foil. **Factory specifications are required.**

PANELS

TALL END PANELS or REFRIGERATOR END PANELS (EP)

Maple
Oak Hickory/White Cherry

3/4" THICK

EP 2484, 2496

EP 3084, 3096

3/4" THICK w/ 1 1/2"-3" SOLID FACE

EP 2484

EP 2496

EP 3084

EP 3096

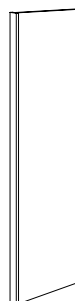

PRODUCT DESCRIPTION

Panel used to conceal the side of a refrigerator or to close off the end of a run of upper and lower cabinets.

V-GROOVE PANEL (VGP)

Maple
Oak Hickory/White Cherry

VGP 48x36

VGP 48x48

VGP 48X96

VGP 96X48



PRODUCT DESCRIPTION

1/4" solid wood veneer panel with V-grooves every 3 1/2" unless otherwise specified.

VALANCES

ARCHED DROP VALANCE (ADV)

Maple
Oak Hickory/White Cherry

ADV 12

ADV 18

ADV 24

ADV 30

ADV 36

ADV 42

ADV 48

ADV 60

ADV 72

ADV 84

ADV 96

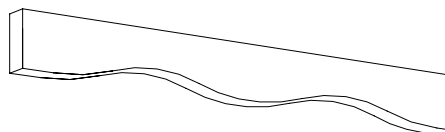

PRODUCT DESCRIPTION

Decorative filler with two shallow arches. The center drops 3/4" to 1 3/4" below the sides of the valance. Valance sides are 5" high.

ARCHED FRET VALANCE (AFV)

Oak Maple
 Hickory/White Cherry

AFV 12
AFV 18
AFV 24
AFV 30
AFV 36
AFV 42
AFV 48
AFV 60
AFV 72
AFV 84
AFV 96

PRODUCT DESCRIPTION

Decorative filler with shallow arch and fret work on either end. Used between wall cabinets or over sink areas. Constructed of solid wood, 5" high, 3/4" thick.

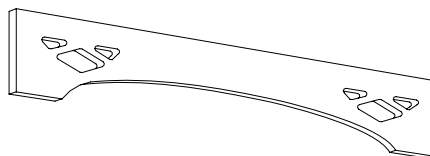

- 42 inch and above are available as multiple arch versions for an additional 10%.

ARCHED VALANCE (AV)

Oak Maple
 Hickory/White Cherry

AV 12
AV 18
AV 24
AV 30
AV 36
AV 42
AV 48
AV 60
AV 72
AV 84
AV 96

PRODUCT DESCRIPTION

Decorative filler with shallow arch. Used between wall cabinets or over sink areas. Constructed of solid wood, 5" high, 3/4" thick.



- 42 inch and above are available as multiple arch versions for an additional 10%.

FRET VALANCE

(FV)

Oak Maple
Hickory/White Cherry

FV 12-24
FV 30-36
FV 42-48
FV 60-84
FV 96

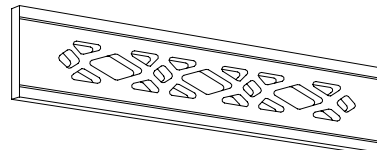

PRODUCT DESCRIPTION

Decorative filler, used between wall cabinets, over sinks or to create custom appearance for open shelves. 5" high, 3/4" thick.

FRET BLANK

(FB)

Oak Maple
Hickory/White Cherry

FB (PER FOOT)

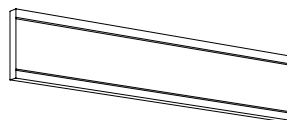

PRODUCT DESCRIPTION

Same size and profile as the Fret Valance, without the fret work.

KEYSTONE VALANCE

(KV)

Oak Maple
Hickory/White Cherry

KV 12
KV 18
KV 24
KV 30
KV 36
KV 42
KV 48
KV 60
KV 72
KV 84
KV 96

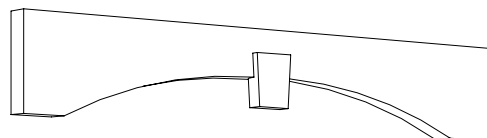

PRODUCT DESCRIPTION

Decorative filler with shallow arch and a wooden block located at the arches' crown. Center block can be trimmed for use with crown molding or shipped unattached. Specify if block should be shipped unattached. 5" high, 3/4" thick.

SCALLOPED VALANCE

(SV)

Oak Maple
 Hickory/White Cherry

SV 18
SV 24
SV 30
SV 36
SV 42
SV 48
SV 60
SV 72
SV 84
SV 96

PRODUCT DESCRIPTION

Decorative valance with multiple ,repeating arches used over windows to conceal lights or between cabinets. 5" high, 3/4" thick.

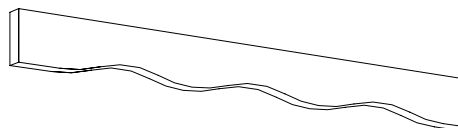

TOE BOARD VALANCE

(TBV)

Oak Maple
 Hickory/White Cherry

TBV 18
TBV 24
TBV 30
TBV 36
TBV 42
TBV 48
TBV 60
TBV 72
TBV 84
TBV 96

PRODUCT DESCRIPTION

Decorative valance typically used at either the top or bottom of book cases or cabinets. 4"- 5" tall. **Please specify height.**

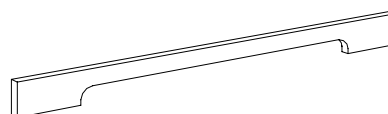

TRADITIONAL VALANCE

(TV)

Oak Maple
 Hickory/White Cherry

TV 18
TV 24
TV 30
TV 36
TV 48
TV 60
TV 72
TV 84
TV 96

PRODUCT DESCRIPTION

Decorative valance with a profile on one edge. 5" high and 3/4" thick.

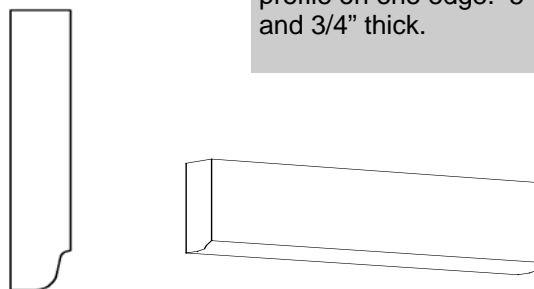

SPECIALTY CARVED WOOD PRODUCTS AVAILABLE THROUGH RAYMOND ENKEBOLL DESIGNS

American Products is pleased to offer Raymond Enkeboll Designs Architectural Woodcarvings to our customers. Raymond Enkeboll Designs represent the highest quality in architectural woodcarvings and are certain to satisfy those customers with even the most discriminating tastes.

When ordering Raymond Enkeboll Designs, the following applies:

- Turn around time may be up to eight (8) weeks.
- All items available in oak, maple, white and cherry only. Cherry is offered at a 30% premium. Maple may be given Cherry finish.
- Sizes listed are the only sizes available.
- Raymond Enkeboll Designs product offerings are subject to change at any time without notice. **ADD A HANDLING FEE IF ORDER IS UNDER \$100.00.**

ENKEBOLL CORBELS

CORBEL TRADITIONAL

(SEE BELOW)

Oak/Maple/White

Cherry

CBL-TX0 2 5/8" W x 2 3/4" D x 4 1/2" H

CBL-TO0 3 1/2" W x 3 7/8" D x 6 5/8" H

CBL-TO1 4 3/4" W x 5 3/4" D x 9 1/2" H

CBL-TM1 5 1/4" W x 4 1/8" D x 12 3/8" H



ENKEBOLL ONLAYS

ONLAY ACANTHUS HORIZONTAL (ONL-AH2)

Oak/Maple/White

Cherry



ONL-AH1 8" W x 2 1/2" H x 1/2" Thick

ONLAY ACANTHUS CORNER (ONL-AC1)

Oak/Maple/White

Cherry



ONL-AC1 4" W x 4" H x 1/2" Thick

ONLAY ACANTHUS TRIM MINI (ONL-AT0)

Oak/Maple/White

Cherry



ONL-AT0 5" W x 2 1/2" H x 1/2" Thick

- Sold in pairs of one left and one right.

ONLAY GRAPE TRIM (ONL-GT1)

Oak/Maple/White

Cherry



ONL-GT1 7" W x 3 3/8" H x 1/2" Thick

- Sold in pairs of one left and one right.

ENKEBOLL ROSETTES

ROSETTE ACANTHUS CIRCLE (ROS-AC1)

	Oak/Maple/White	Cherry
ROS-AC1 4 1/2" Diameter x 3/4" Thick	191.00	249.00



ROSETTE LEAF SQUARE BLOCK (ROS-LS1)

	Oak/Maple/White	Cherry
ROS-LS1 3 1/2" Square x 1 3/4" Thick		

DISCONTINUED
LIMITED QUANTITIES
AVAILABLE



ROSETTE FLORAL CIRCULAR (SEE BELOW)

	Oak/Maple/White	Cherry	
ROS-FC0 2 3/4" Diameter x 1/2" Thick			ROS-FC0
ROS-FC1 4 3/8" Diameter x 3/4" Thick			

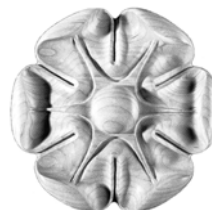

ROS-FC1

BUN FEET & TULIP FEET

STANDARD BUN FOOT

(BFS)

Oak

Maple/White

Cherry

BFS 3" High

BFS 4" High

- Standard Bun Foot is 5" diameter.
- Additional piece can be added to either bun to build up to 4" or 4 1/2" high. Please specify.

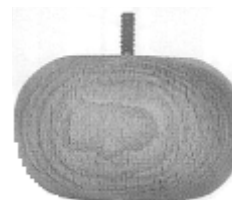

STANDARD BUN FOOT w/ BEAD

(BFB)

Oak

Maple/White

Cherry

BFB 3" High

- Standard Bun Foot w/ Bead is 5" diameter.
- Additional piece can be added to build up to 4" or 4 1/2" high. Please specify.



REEDED BUN FOOT

(BFR)

Oak

Maple/White

Cherry

BFR 3" High

BFR 4" High

- Standard Bun Foot is 5" diameter.
- Additional piece can be added to either bun to build up to 4" or 4 1/2" high. Please specify.



TULIP "BUN" FOOT

(TLP)

Oak

Maple/White

Cherry

TLP 4" High

TLP 4 1/2" High

- Standard Tulip Foot is 3 1/4" diameter at the top and approximately 2" at the bottom.



REEDED & FLUTED POSTS

REEDED TURNED POSTS (TPR)

Oak

Maple/White

Cherry

TPR 3 1/2" x 31 1/2"

TPR 3 1/2" x 34 1/2"

TPR 4 1/2" x 31 1/2"

TPR 4 1/2" x 34 1/2"

- Above posts are available halved. Call or fax for pricing and specifications.

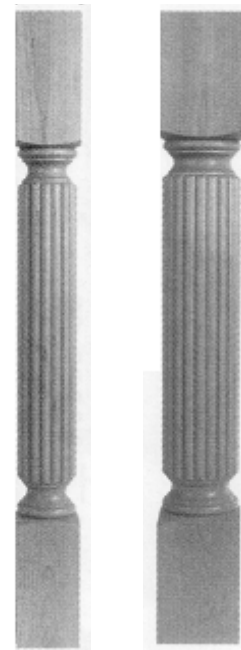

FLUTED TURNED POSTS (TPF)

Oak

Maple/White

Cherry

TPF 3 1/2" x 31 1/2"

TPF 3 1/2" x 34 1/2"

TPF 4 1/2" x 31 1/2"

TPF 4 1/2" x 34 1/2"

- Above posts are available halved. Call or fax for pricing and specifications.

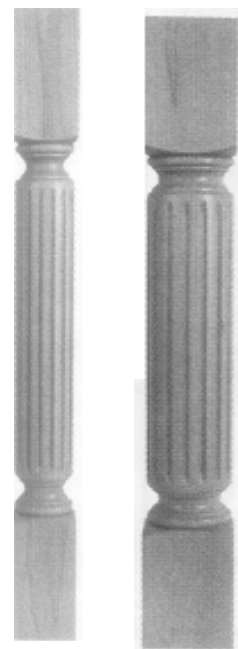

[american products](#)

Phone: 419-878-9582 Fax: 419-878-9580

Architectural Carvings

CORBEL ACANTHUS (CA)

Oak/Maple/White

Cherry

CA 7	3" x 3 1/8" x 7"
CA 10	4" x 4 1/4" x 10"
CA 12	4 7/8" x 5 1/4" x 12"
CA 14	5 1/2" x 6 1/4" x 14"



CORBEL GRAPE (CG)

Oak/Maple/White

Cherry

CG 7	3" x 3 1/8" x 7"
CG 10	4" x 4 1/4" x 10"
CG 12	4 7/8" x 5 1/4" x 12"
CG 14	5 1/2" x 6 1/4" x 14"



SQUARE ONLAYS (CVS)

Oak/Maple/White

Cherry

CVS 3	2 1/2" x 1/2"
CVS 4	3 5/8" x 3/4"



ROUND ONLAYS (CVR)

Oak/Maple/White

Cherry

CVR 3	2 1/2" x 5/8"
CVR 4	3 5/8" x 5/8"



AMERICAN PRODUCTS QUANTITY MOLDING PROGRAM

American Products and the Advantage Line are now offering a variety of stock moldings to our valued customers.

Our moldings are solid wood and wood veneer construction and come in 8-foot lengths, available in oak, maple, cherry, hickory and paint grade. We will color match them to your required cabinet line, then provide them to you in carton quantities. We will also provide you with a lead-time that is typically two weeks and the best customer service that we know how.

Pricing for the molding program is for carton quantities only. (*with the exception of items that have a carton quantity of 1, you must order a minimum of 5 cartons*) The quantities for each carton are listed in the bulleted section for each specific molding. Prices shown are per piece within that carton.

Looking for something not shown here? Please feel free to call or fax us with your specifications and allow **American Products** to give you a quote!

Competitive pricing, high quality and reasonable lead times are what we stand for!

AMERICAN PRODUCTS QUANTITY MOLDING PROGRAM

CLASSIC CROWN MOLDING (CCM)

Oak Maple
Hickory/White Cherry

CCM 96

- Carton quantities only - 6 pcs.
- Solid wood molding
- 2 3/4" rise and run
- 3 3/4" face

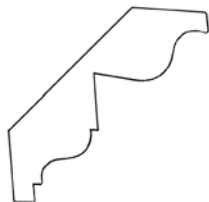

CLASSIC CROWN w/ CLEAT (CCM-C)

Oak Maple
Hickory/White Cherry

CCM-C 96

- Carton quantities only - 6 pcs.
- Solid wood molding with a 2" cleat attached
- Can be used with full overlay doors and frameless cabinets



LARGE CROWN MOLDING (CML)

Oak Maple
Hickory/White Cherry

CML 96

- Carton quantities only - 6 pcs.
- Solid wood molding
- 3 1/2" rise
- 2 1/2" run
- 4 1/4" face



LARGE CROWN w/ CLEAT (CML-C)

Oak Maple
Hickory/White Cherry

CML-C 96

- Carton quantities only - 6 pcs.
- Solid wood molding with a 2" cleat attached.
- Can be used with full overlay doors and frameless cabinets

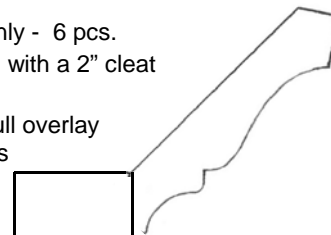

STANDARD CROWN MOLDING (CMS)

Oak Maple
Hickory/White Cherry

CMS 96

- Carton quantities only - 15 pcs.
- Solid wood molding
- 2" rise and run
- 2 3/4" face



STANDARD CROWN w/ CLEAT (CMS-C)

Oak Maple
Hickory/White Cherry

CMS-C

- Carton quantities only - 6 pcs.
- Solid wood molding with a 2" cleat attached.
- Can be used with full overlay doors and frameless cabinets

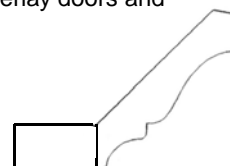

AMERICAN PRODUCTS QUANTITY MOLDING PROGRAM

CONTEMPORARY CROWN (CTCM)

Oak Maple
 Hickory/White Cherry

CTCM 96

- Carton quantities only - 6 pcs.
- Solid wood molding
- 2 5/8" rise and run
- 3 3/4" face

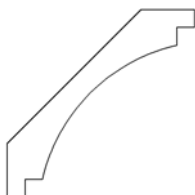

SOFFIT CROWN MOLDING (SCM)

Oak Maple
 Hickory/White Cherry

SCM 96

- Carton quantities only - 20 pcs.
- Solid wood molding
- 1 3/16" rise and run
- 1 5/8" face



SOFFIT CROWN w/ CLEAT (SCM-C)

Oak Maple
 Hickory/White Cherry

SCM-C 96

- Carton quantities only - 15 pcs.
- Solid wood molding with a 2" cleat attached.
- Can be used with full overlay doors and frameless cabinets



ANGLE OUTSIDE CORNER (AOC)

Oak Maple
 Hickory/White Cherry

AOC 96

- Carton quantities only - 5 pcs.
- Solid wood molding
- 3/4" along each face
- 135 degree angle

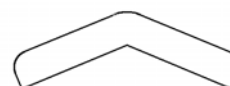

3/4" BATTEN MOLDING (BM)

Oak Maple
 Hickory/White Cherry

BM 96

- Carton quantities only - 25 pcs.
- Solid wood molding
- 1/4" x 3/4"



1" BATTEN MOLDING (BM1)

Oak Maple
 Hickory/White Cherry

BM1 96

- Carton quantities only - 25 pcs.
- Solid wood molding
- 1/4" x 1"



AMERICAN PRODUCTS QUANTITY MOLDING PROGRAM

COUNTERTOP MOLDING (CTM)

Oak Maple
 Hickory/White Cherry

CTM 96

- Carton quantities only - 10 pcs.
- Solid wood molding
- Decorative edge for countertops
- 3/4" x 1 1/2"



DENTIL MOLDING (DM)

Oak Maple/White Cherry

DM 96

- Carton quantities only - 10 pcs.
- Solid wood molding
- 1/4" x 5/8"

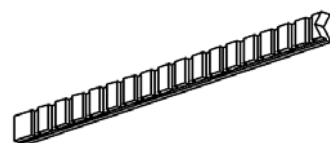

INSIDE CORNER MOLDING (ICM)

Oak Maple
 Hickory/White Cherry

ICM 96

- Carton quantities only - 30 pcs.
- Solid wood molding
- 3/4" x 3/4"



3/4" OUTSIDE CORNER MOLDING (OCM)

Oak Maple
 Hickory/White Cherry

OCM 96

- Carton quantities only - 20 pcs.
- Solid wood molding
- 1/4" thick with 3/4" faces



1" OUTSIDE CORNER MOLDING (OCM1)

Oak Maple
 Hickory/White Cherry

OCM1 96

- Carton quantities only - 20 pcs.
- Solid wood molding
- 1/4" thick with 1" faces

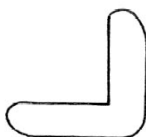

QUARTER ROUND MOLDING (QRM)

Oak Maple
 Hickory/White Cherry

QRM 96

- Carton quantities only - 20 pcs.
- Solid wood molding
- 3/4" x 3/4"



AMERICAN PRODUCTS QUANTITY MOLDING PROGRAM

RADIUS CABINET MOLDING (RCM)

Oak Maple
Hickory/White Cherry

RCM 96

- Carton quantities only - 3 pcs.
- Solid wood molding
- 1 1/2" x 2 1/2" with a 7/8" x 3/4" notch

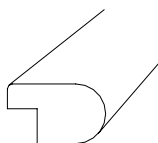

ROPE MOLDING (RM)

Oak Maple
Hickory/White Cherry

RM 96

- Carton quantities only - 10 pcs.
- Solid wood molding
- 3/8" x 3/4"

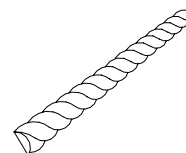

SCRIBE MOLDING (SB)

Oak Maple
Hickory/White Cherry

SB 96

- Carton quantities only - 30 pcs.
- Solid wood molding
- 1/4" x 3/4"



SHOE MOLDING (SHM)

Oak Maple
Hickory/White Cherry

SHM 96

- Carton quantities only - 20 pcs.
- Solid wood molding
- 1/2" x 3/4"



TOE KICK COVER 4" (TK4)

Oak Maple
Hickory/White Cherry

TK4 96

- Carton quantities only - 15 pcs.
- 3/16" solid wood veneer

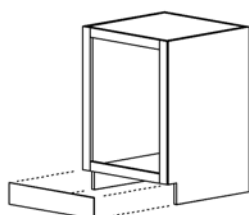

TOE KICK COVER 4 1/2" (TK45)

Oak Maple
Hickory/White Cherry

TK45 96

- Carton quantities only - 15 pcs.
- 3/16" solid wood veneer

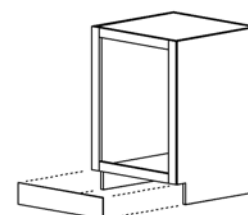

AMERICAN PRODUCTS QUANTITY MOLDING PROGRAM

UNDER CABINET MOLDING (UCM)

Oak Maple
Hickory/White Cherry

UCM 96

- Carton quantities only - 3 pcs.
- Solid wood molding
- 3/4" x 2 1/4" with a 1/4" x 1/2" notch



BASE FILLERS 1", 2", 3", 6" (BF1)(BF2)(BF3)(BF6)

Oak Maple
Hickory/White Cherry

BF1
BF2
BF3
BF6

- Carton quantities only - BF1 (15 pcs), BF2 (10 pcs), BF3 (10 pcs), BF6 (5 pcs)
- Solid wood fillers 34 1/2" high

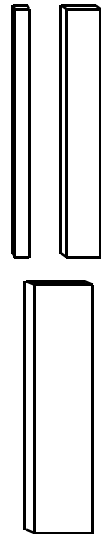

FILLERS 3" & 6"

Oak Maple
Hickory/White Cherry

F342
F384
F396

F642
F684
F696

- Carton quantities only - F342 (8 pcs), F642 (4 pcs), all others 1 pc. Per carton.
- Solid wood fillers



BASE END PANELS

Oak Maple
Hickory/White Cherry

BEP 23 1/4"
BEP 48"
BEP 96"

- Carton quantities only - 23 1/4" and 48" (3 pcs), 96" (2 pcs)
- 3/16" solid wood veneer
- All panels 34 1/2" high

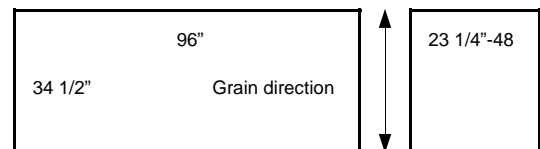

FULL HEIGHT PANELS

Oak Maple
Hickory/White Cherry

FHP 84"

FHP 96"

- Carton quantities only - 4 pcs.
- 3/16" solid wood veneer
- All panels 23 1/4" wide

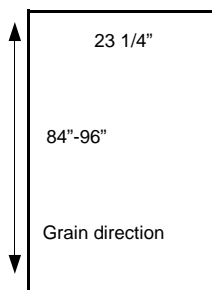

FLAT PANELS

Oak Maple
Hickory/White Cherry

FP 18"
FP 30"
FP 36"

- Carton quantities only - 4 pcs.
- 3/16" solid wood veneer
- All panels 96" high

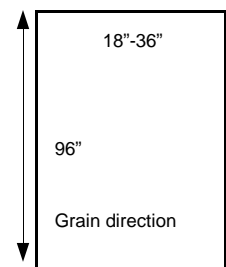

AMERICAN PRODUCTS QUANTITY MOLDING PROGRAM

PANEL BACKERS

(PB)

Oak Maple
Hickory/White Cherry

PB 84"
PB 96"
PB-S 96"

- Carton quantities only - 2 pcs.
- 3/16" solid wood veneer
- PB are 48" wide, PB-S 48" high

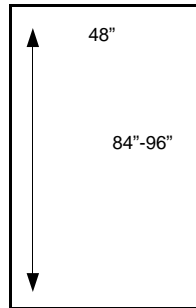
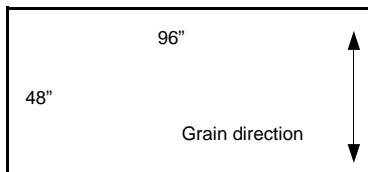

WALL END PANELS

(WEP)

Oak Maple
Hickory/White Cherry

WEP 30"
WEP 36"
WEP 42"

- Carton quantities only - 3 pcs.
- 3/16" solid wood veneer
- All panels are 11 1/4" wide

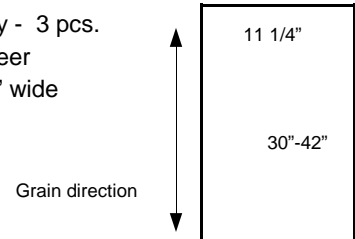

ARCHED VALANCE

(AV)

Oak Maple
Hickory/White Cherry

AV 3'
AV 4'
AV 5'
AV 6'
AV 7'
AV 8'

- Carton quantities only - 5 pc.
- Solid wood
- 5" high



FRET VALANCE

(FV)

Oak Maple
Hickory/White Cherry

FV 3'
FV 4'
FV 5'
FV 6'
FV 7'

- Carton quantities only - 5 pc.
- Solid wood
- 5" high

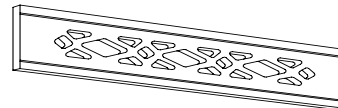

SCALLOPED VALANCE

(SV)

Oak Maple
Hickory/White Cherry

SV 3'
SV 4'
SV 5'
SV 6'
SV 7'
SV 8'

- Carton quantities only - 5 pc.
- Solid wood
- 5" high



TRADITIONAL VALANCE

(TV)

Oak Maple
Hickory/White Cherry

TV 3'
TV 4'
TV 5'
TV 6'
TV 7'
TV 8'

- Carton quantities only - 5 pc.
- Solid wood
- 5" high

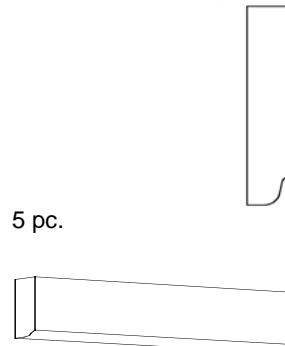

CUSTOM GALLERY OBJECTS

Here at american products we can create just about anything.....Here's why!



We are based in a custom cabinet shop that has been in business for over 50 years. With that kind of longevity in this business we have seen it all, from your basic entertainment units and den cabinetry.....

.....to mantles and many other intricately detailed pieces.

Let your imagination run wild!!

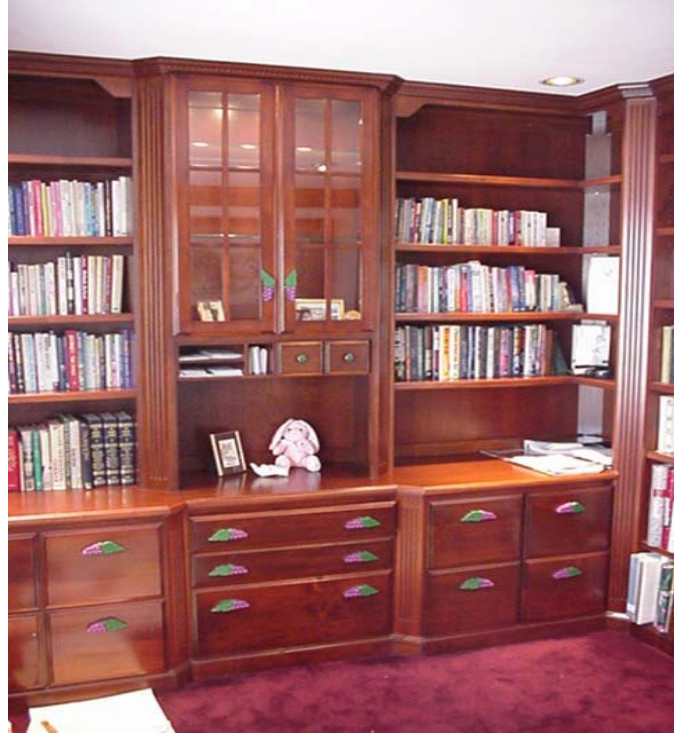

Just fax a drawing of what you have in mind and let us help you design, work out the details and quote it for you. If you have questions, feel free to call and we will help you in whatever way we can.

[american products](#)

Phone: 419-878-9582 Fax: 419-878-9580

CUSTOM GALLERY OBJECTS

We can also modify standard catalog pieces or create new products necessary to accommodate the many needs of your customers. The possibilities are endless.



Wall Open Cabinet with an Arched Valance (AV) and a Desk Organizer



Lattice Wine Rack Cabinet (L/CAB) with Fret Valance (FV) and Standard Corbels (CBL).



Wine Shelf-Vertical (WS-V) made into a base cabinet 18"W with 3 rows of shelves.



Wall Open Cabinet with Raised Panel Doors (RPD) and a Desk Organizer (DO).



Special Countertop cabinet incorporating a Plate Rack (PR), Spice Drawer Bank (SDB) and Fret Valance (FV).



Lattice Wine Rack Cabinet (L/CAB) with Raised Panel Doors (RPD).

DATE ____/____/____

Customer Fax From _____

SOLD TO (This fax is from)

SHIP TO (Leave Blank if Same as SOLD TO)

_____	_____
_____	_____
_____	_____
_____	_____

If you have any questions regarding this fax, contact:

at (____) _____ Our fax # is (____) _____

Our Purchase order # is:

COMMENTS:

ITEM

QTY

SIZE

BRAND/STYLE

WOOD/COLOR

_____	_____	_____	_____	_____
_____	_____	_____	_____	_____
_____	_____	_____	_____	_____
_____	_____	_____	_____	_____
_____	_____	_____	_____	_____
_____	_____	_____	_____	_____

[american products](#)

Phone: 419-878-9582 Fax: 419-878-9580